

# moon hermetic & open chamber wall hung boiler

Thanks to Baykan room thermostat which can be assembled to your room as an option, you can adjust or stabilize the room temperature thus you can obtain savings of energy consumption reaching 20%.

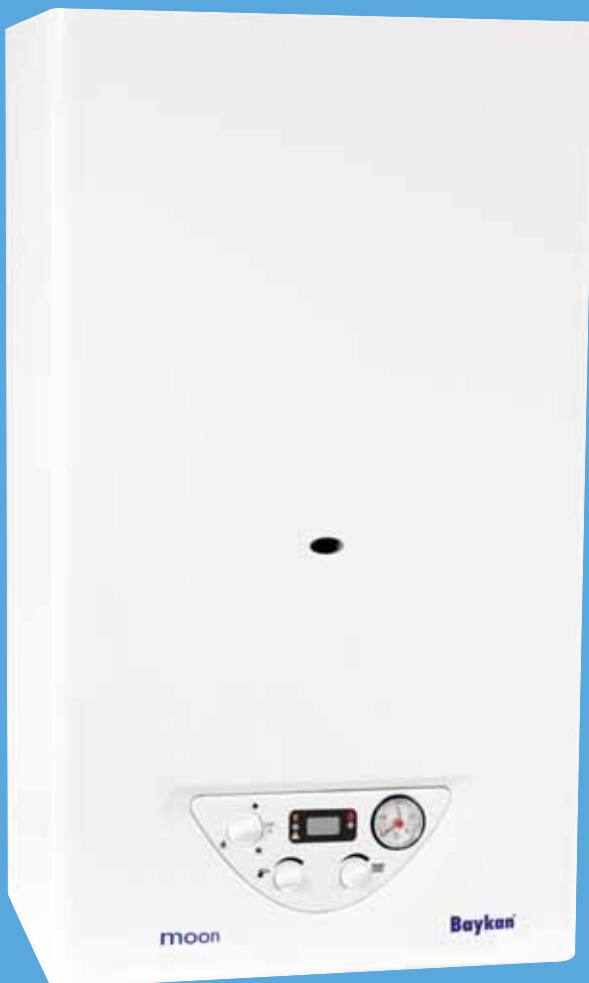

## → moon



- Small dimensions and light weight
- Micro processor controlled board
- Anti freezing protection system
- Accurate temperature adjustment on central heating circuits  $\pm 1^{\circ}\text{C}$
- Timer room thermostat connection bracket
- Electrical three way valve
- Pump feature that does not allow the pump run without water
- Automatic by-pass system
- Overheat sensor
- Secondary water exchanger
- Electronic ignition
- Ignition control with ionization electrode
- Pump anti-blockage system
- Easily adjustable circulation pump
- Low NOx level
- Electronic full modulation
- Ergonomical and digital controlling board
- Operability with natural gas and LPG
- Lower gas consumption, higher efficiency
- Anti-calc system against calcifying

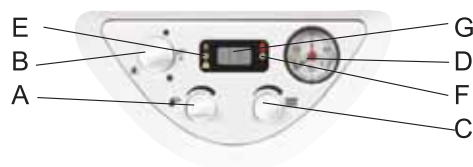

- A- Domestic water temperature adjustment button
- B- OFF -RESET button and SUMMER/ WINTER adjustment
- C- Central heating circuit temperature adjustment button
- D- Manometer (pressure gauge)
- E- Power gauge
- F- Flame indicator
- G- Displays the temperature of heating system or break downs as it flashes



2 years warranty





24/28 kW Hermetic Monotermic

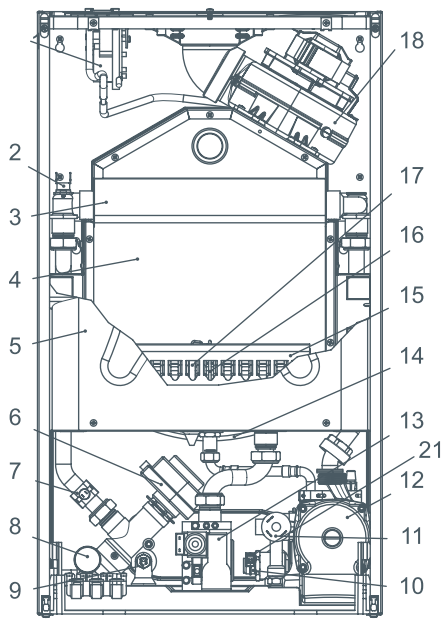

24/28 kW Open Chamber wall hung boiler

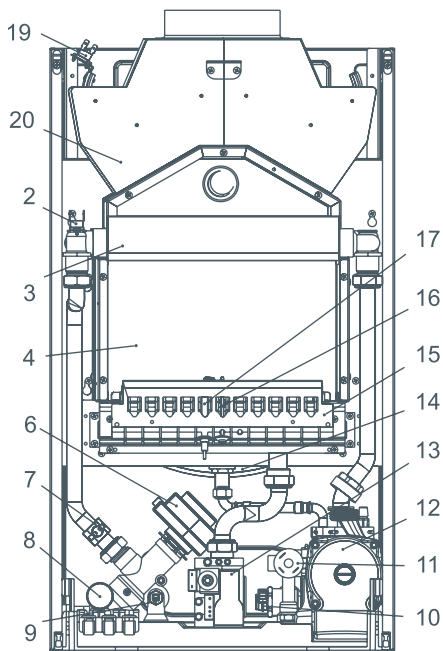

### Technical Specifications

	Open Chamber 240C 20.726 kcal/h	Open Chamber 280C 24.940 kcal/h	Hermetic 24SC 21.414 kcal/h	Hermetic 28SC 24.940 kcal/h 24BT	Hermetic 32SC 27.520 kcal/h 24BT
Class	II2H3 + 3B/P				
PIN	-				
NOx type	3				
Type	BIBBs C12-C32-C42-C52-C62-C82-B32				
Type of Gas	Natural Gas(G20), LPG(G30-G31)				
Min/ max. Heat input	kW 9/ 26.5	10/ 31	9/ 26.5	10/ 31	3/34.5
Min/max. Heat output	kW 7.5/ 24.1	8.4/ 29	7.6/ 24.9	8.4/ 29	11/32
Efficiency (Max. Efficiency)	% 91	91	93.2	93.7	92.8
Efficiency at 30% capacity	% 89	89	91.7	91.5	90.5
Fume temperature	°C 105	105	127	134	145
<b>Central Heating Circuit</b>					
Heating circuit water temperature	°C 40-85				
Expansion tank capacity	lit 7.0				
Expansion tank pressure	bar 1.0				
Heating circuit working pressure	bar 3.0				
Max heating circuit water temperature	°C 90				
<b>Domestic Hot Water Circuit</b>					
Domestic hot water production (Δt=25 °C)	lit/min 13.8	16.2	14.2	16.0	18.3
Domestic hot water production (Δt=30 °C)	lit/min 11.5	13.3	12.0	13.8	15.3
Min./Max.pressure on DHW system	bar 0.8/ 6.0				
Domestic hot water temperature Min/max	°C 30/ 60				
<b>Electrical Circuit</b>					
Power supply voltage / frequency	V 230 V(± 15 V), 50 Hz				
Electrical power	W 104	104	152	152	152
Grade of protection	IP X4D				
<b>Dimension</b>					
Width/Height/Depth	mm 400/700/330				
Weight	kg 38	40	40	41	42
CH circuit inlet/outlet	inch 3/4"				
DHW inlet/outlet	inch 1/2"				
Gas circuit	inch 3/4"				
Flue pipe diameter	mm 130	140	60/100		
Flue pipe length min/max	m 0.5/ 5.0 + elbow				
Parallel flue pipe / pipe inlet dimension	mm 80/ 80				
<b>Gas Nozzle Pressures</b>					
Natural gas (G20 max)	mbar 1.4/ 11.5	1.4/ 13.1	1.4/ 11.5	1.4/ 13.1	1.8/ 12.8
LPG (G30 / G31 max)	mbar 3.8/ 27.5	3/ 27.4	3.8/ 27.5	3/ 27.4	4/ 27.7
LPG (G30 / G31 min)	mbar 4.6/ 35.3	3.8/ 35.2	4.6/ 35.3	3.8/ 35.2	5.5/ 35.6
Ø Natural gas nozzle dimension	mm 1.30				
Ø LPG nozzle dimension	mm 0.77	0.78	0.77	0.78	0.78
<b>Gas Circuit</b>					
Natural gas G20	mbar 20				
LPG (G30/G31)	mbar 29/ 37				
Natural gas consumption	m³/h 2.74	3.2	2.74	3.2	3.6

- 1- Air pressure switch
- 2- Safety thermostat
- 3- Main heat exchanger
- 4- Combustion chamber
- 5- Combustion chamber tap
- 6- Electrical three way valve
- 7- Central heating system water sensor NTC
- 8- Safety valve
- 9- Domestic water heat sensor NTC
- 10-Domestic water flow sensor

- 11-Pressure safety switch (transducer)
- 12-Circulation pump
- 13-Burner valve
- 14-Expansion vessel
- 15-Burner
- 16-Ground electrode
- 17-Ignition electrode
- 18-Fan
- 19-Domestic water heat exchanger